



Newtown Road, Hereford, HR4 9LE

# Property Description

**\*\*DEPOSIT ALTERNATIVE OPTION  
AVAILABLE\*\***

Located within walking distance of Hereford City Centre and all its amenities, we are pleased to present this beautiful two bedroom top floor apartment. There is a spacious lounge area, fully fitted, modern kitchen, two double bedrooms and a modern shower room. The property also benefits from two allocated parking spaces.

Located within walking distance of the medical centre, train station and hospital, this is the ideal property for someone looking to live close to the city centre.







## Key Features

- Located within Walking Distance of Hereford City Centre
- Ideally Located for Hospital & Medical Centre
- Spacious Lounge
- Two Double Bedrooms
- Modern Shower Room
- Off Road Parking
- Available Mid September

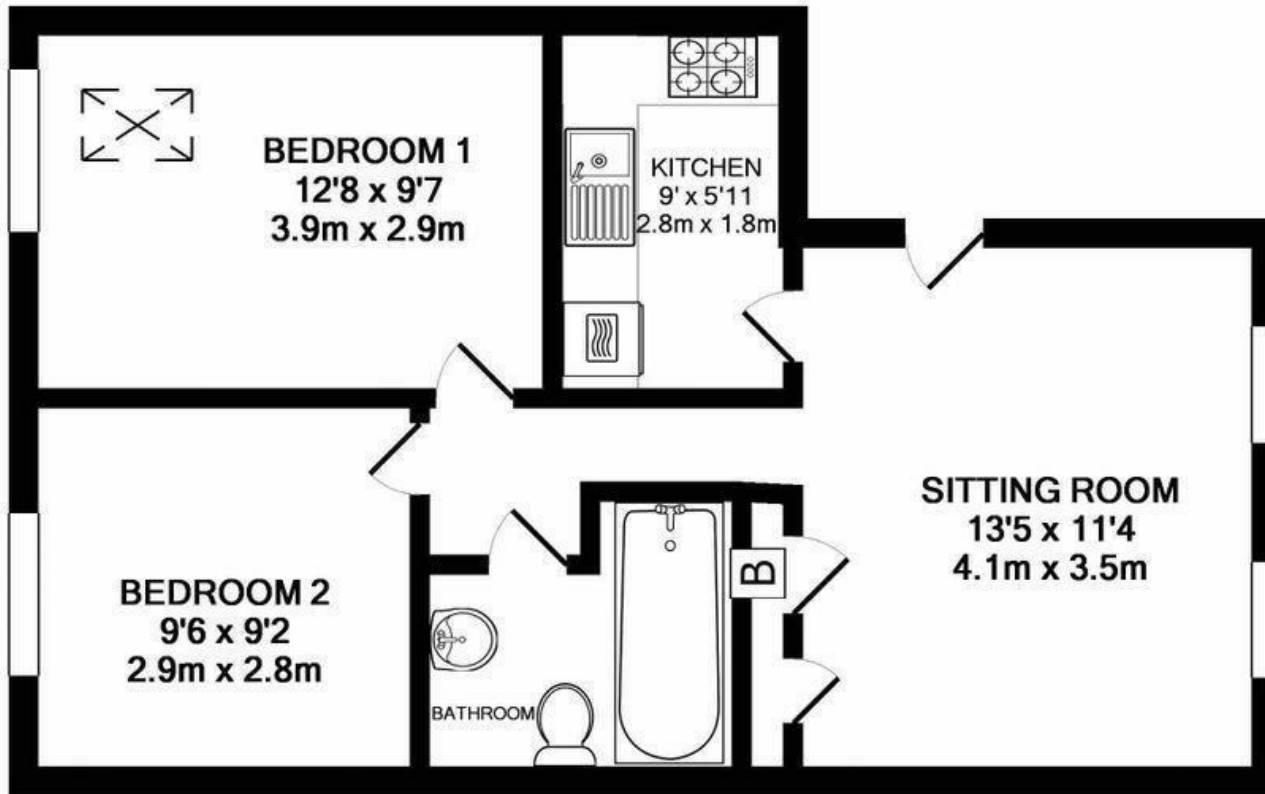

TOTAL APPROX. FLOOR AREA 497 SQ.FT. (46.2 SQ.M.)

Whilst every attempt has been made to ensure the accuracy of the floor plan contained here, measurements of doors, windows, rooms and any other items are approximate and no responsibility is taken for any error, omission, or mis-statement. This plan is for illustrative purposes only and should be used as such by any prospective purchaser. The services, systems and appliances shown have not been tested and no guarantee as to their operability or efficiency can be given  
Made with Metropix ©2017

**£950 PCM**